

REVISIONS	DATE	BY	CK'D
Rev. Drainage Inverts	9/16/86 M.A.		
Rev. Handicapped parking location	9/19/86 P.H.		
	11/18/87 M.A.		
Rev. Grading	2/5/87 M.A.		
Rev. Sidewalk per Client	2/11/87 R.C.		

SCALE: 1"=40'	DATE: SEPT. 1, 1986	BY: R.A.C.	CK'D: [Signature]	F.B.: P.G.	JOB NO.: 86-168
---------------	---------------------	------------	-------------------	------------	-----------------

NOTE: SEE TYPICAL PARKING LOT DETAIL SHEET 7 OF 18 FOR GRADING OF PARKING AREAS UNLESS OTHERWISE GRADED

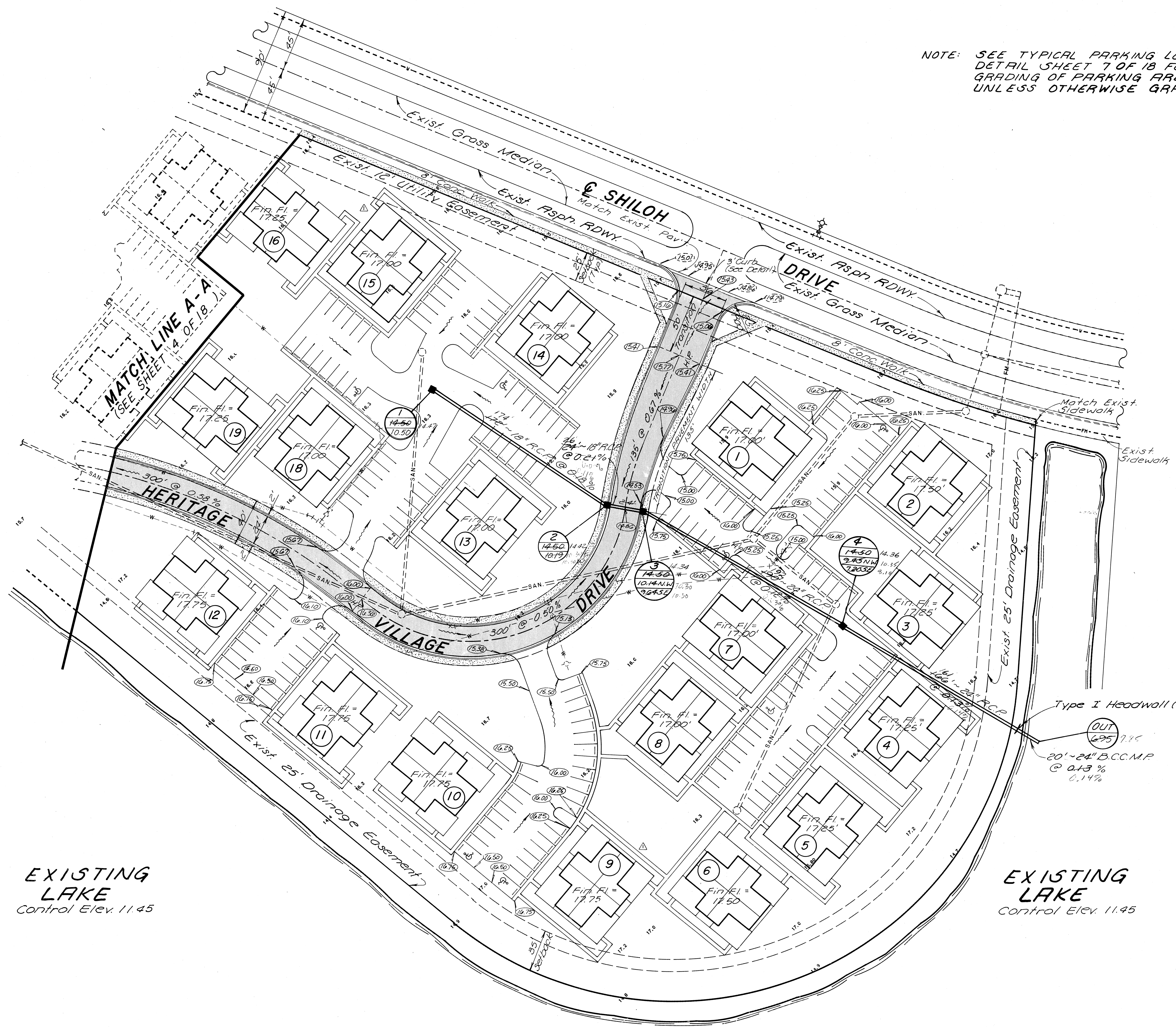
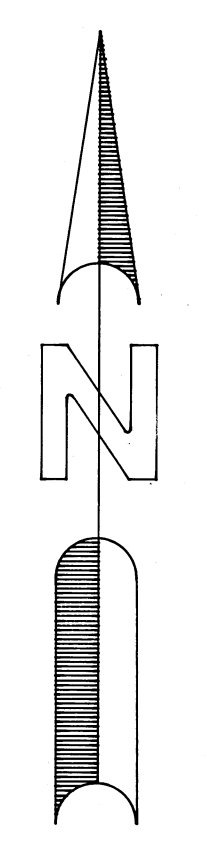

LEGEND

EXISTING STORM SEWER WITH CATCH BASIN	---ST---
STORM SEWER LINE WITH JUNCTION BOX	—●—
STORM SEWER LINE WITH CATCH BASIN	—■—
SANITARY SEWER LINE WITH MANHOLE	---SAN---○---
SEWAGE FORCE MAIN	---FM---
WATERLINE	---W---
PROPOSED ELEVATION	① 16.56
EXISTING ELEVATION	② 16.11
HIGH POINT	H.P.
DIRECTION OF FLOW	→
FINISHED FLOOR ELEVATION	FIN. FL. =
STRUCTURE NUMBER	① 00
GRATE/RIM ELEVATION	① 00.00
F.L. ELEVATION	① 00.00
EX. STRUCTURE NUMBER	① 00
EX. GRATE/RIM ELEVATION	① 00.00
EX. F.L. ELEVATION	① 00.00

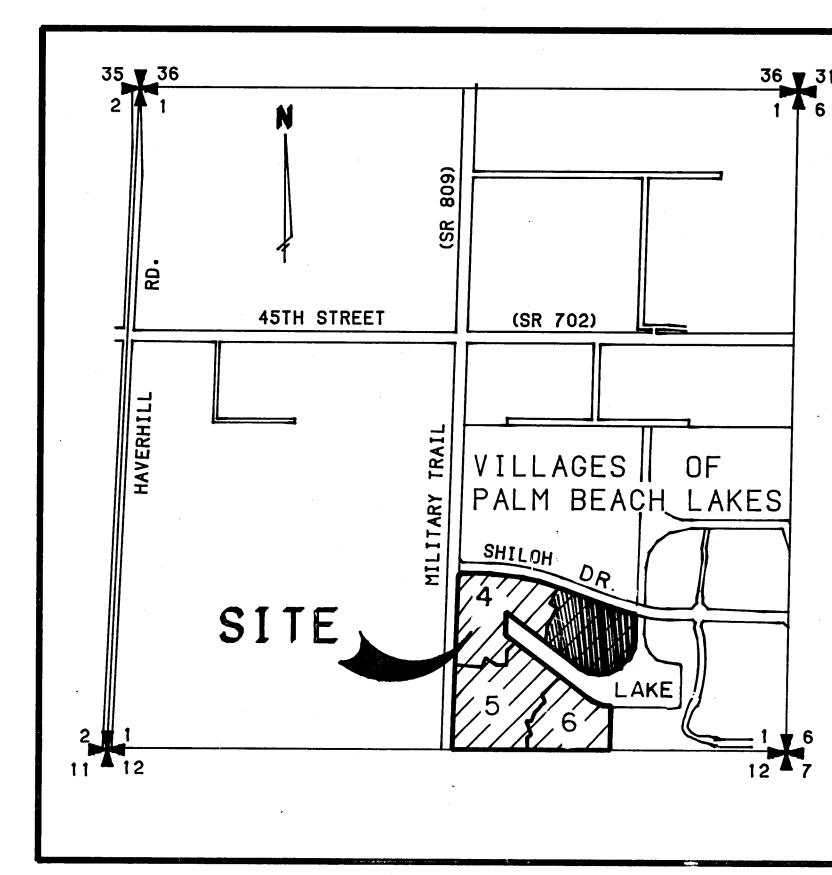

LOCATION MAP SECTION 1-43S-42E

EXISTING LAKE
Control Elev. 11.45

EXISTING LAKE
Control Elev. 11.45