

**EXISTING LAKE**  
Control Elev. 11.45

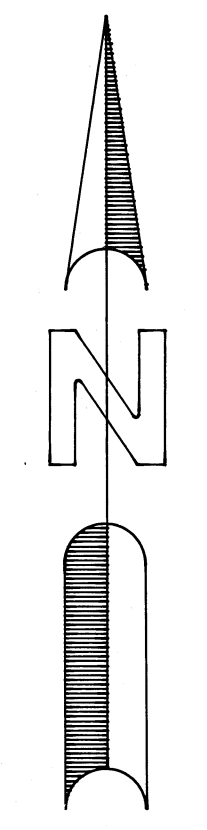

**LEGEND**

EXISTING STORM SEWER WITH CATCH BASIN	---ST---[ ]---ST---
STORM SEWER LINE WITH JUNCTION BOX	---[ ]---
STORM SEWER LINE WITH CATCH BASIN	---[ ]---
SANITARY SEWER LINE WITH MANHOLE	---SAN---[ ]---SAN---
SEWAGE FORCE MAIN	---FM---
WATERLINE	---W---
PROPOSED ELEVATION	(16.56)
EXISTING ELEVATION	(16.11)
HIGH POINT	H.P.
DIRECTION OF FLOW	~>
FINISHED FLOOR ELEVATION	FIN. FL. =
STRUCTURE NUMBER	00
GRATE/RIM ELEVATION	*00.00
F.L. ELEVATION	00.00
EX. STRUCTURE NUMBER	00
EX. GRATE/RIM ELEVATION	*00.00
EX. F.L. ELEVATION	00.00
TYPICAL BUILDING No.	(1)

NOTE: SEE TYPICAL PARKING LOT DETAIL SHEET 7 OF 18 FOR GRADING OF PARKING AREAS UNLESS OTHERWISE GRADED

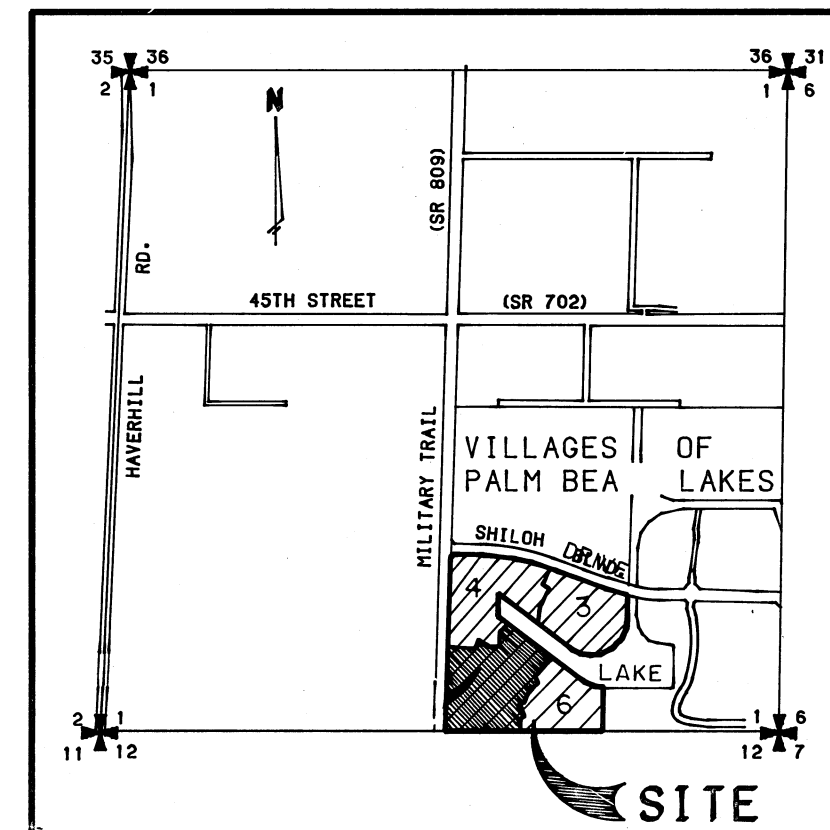

**LOCATION MAP**  
SECTION 1-43S-42E

Z06F16803  
SHEET 5 OF 18

**LAWSON, NOBLE & ASSOCIATES, INC.**  
ENGINEERS PLANNERS TESTING SURVEYORS  
1501 CORPORATE DRIVE SUITE 150  
BOYNTON BEACH, FLORIDA 33435 PH: (305) 736-9944

**PAVING, GRADING, AND DRAINAGE PLAN**  
FOR  
**HERITAGE VILLAGE**

REVISIONS	DATE	BY	CHK'D
Rev. Drainage Inverts	9/16/88 M.A.		
Rev. Recreation Area	1-9-89 R.C.		
As-Built	1/19/87 R.M.		
Rev. Sidewalk per Client	5/11/87 R.C.		

SCALE: 1"=40'  
DATE: SEPT. 1988  
BY: R.A.C.  
CHK'D: [Signature]  
F.B. PG.  
JOB NO: 86-168

FILE NO. **86-168**